

RATCHET COMBINATION WRENCHES - METRIC



Description :

- ISO 691 - ISO 1711-1
- 5° increment.
- 12-point OGV® ring angled at 15°.
- Open end angled at 15° from the handle axis (increment angle 30°).
- OGV® Ring profile maximizing contact surface with the nut for a longer lifetime.
- Switch to change ratcheting direction built into handle to prevent accidental change.
- Forged in Chrome Vanadium steel.
- High chrome finish.

Conditioning :

1

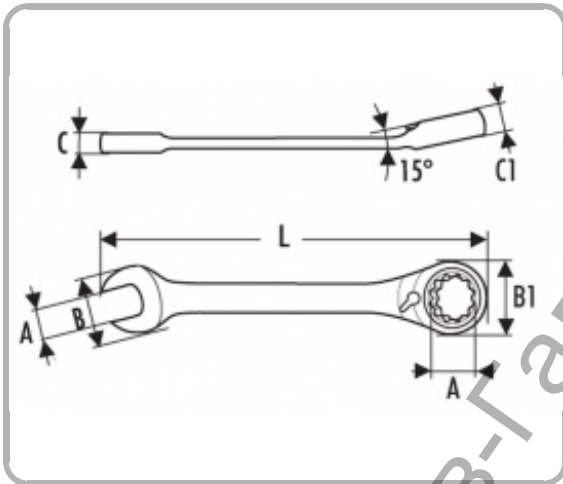

References :

	EAN	A [mm]	B [mm]	B1 [mm]	C [mm]	C1 [mm]	L [mm]	[g]
E113300	3258951133002	11	25	22.6	5.9	8	167	68
E113301	3258951133019	8	18.5	17.7	5	7.7	135	32
E113302	3258951133026	9	20.5	19	5.3	7.7	142	40
E113303	3258951133033	10	22.5	21.2	5.8	8	158	56
E113304	3258951133040	12	26.9	23.8	6.1	8	173	78
E113305	3258951133057	13	29	25.9	6.6	8.9	179	96
E113306	3258951133064	14	31.5	27.7	7.5	9	189	116
E113307	3258951133071	15	34	29.2	7.9	9.4	199	136

<u>E113308</u>	3258951133088	16	35	31.8	7.9	9.9	215	160
<u>E113309</u>	3258951133095	17	38	34.1	8	10.6	232	182
<u>E113310</u>	3258951133101	18	40.1	34	8.5	11	238	200
<u>E113311</u>	3258951133118	19	42	35.1	8.9	11.2	247	248
<u>E113460</u>	3258951134603	32	64.5	59.5	13	17	425	970
<u>E117370</u>	3258951173701	21	45.3	41.5	10.3	13	285	540
<u>E117371</u>	3258951173718	22	45.3	41.5	10.3	13	285	540
<u>E117372</u>	3258951173725	24	52	47	10.8	14.5	325	710
<u>E117373</u>	3258951173732	27	58.6	52	12.5	15	359	750
<u>E117374</u>	3258951173749	30	64.5	59.5	13	17	425	970
<u>E117377</u>	3258951173770	6	16.3	17.7	5	7.7	124	28
<u>E117378</u>	3258951173787	7	16.3	17.7	5	7.7	124	28

Ташев-Галвинг ООД
www.tashev-galving.com